

TWP-W2265THK(W) 快速指引

首次使用

· 產品首次使用請按照指引操作，可延長濾芯使用壽命。

1. 打開包裝，將機器放置在穩固的平面上及擺放接水盤。

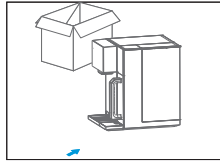

2. 取水箱步驟：

2.1 取下水箱蓋；

2.1 提起水箱把手往外拉動水箱，待與底座鬆動後再往外提起。

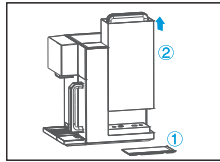

3. 注水：

往水箱中加自來水至最高水位。

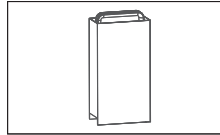

4. 裝上水箱：

4.1 將水箱對準底座插孔往下壓；

4.2 蓋上水箱蓋，此時水箱蓋頂部與機身頂部平齊。

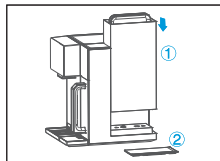

5. 沖洗濾芯：

5.1 把水箱放置回機器，機器開始進行自動清洗，沖洗濾芯，分三次進行，沖洗時間為5分鐘，顯示屏顯示沖洗倒計時300秒。

5.2 濾芯沖洗結束後，缺水圖標閃爍，提示用戶去換水，此時，需要將原水箱的水全部倒掉，並重新加水至最高水位附近。

5.3 重複 5.1、5.2 步驟三次。

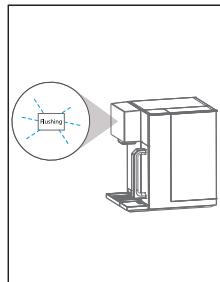

6. 開始制水：

水箱接第四箱水，開始制水。新機器制水時間需要約10~15分鐘，請耐心等待。

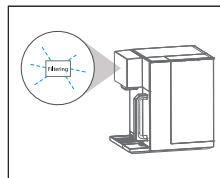

7. 制水完成後，按“常溫水”鍵排出適量的水清洗內部管路及出水咀，機器可正常使用。（可選擇）

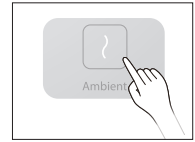

8. 當首次啟動機器時，為原水箱注滿水後，機器開始過濾水，待淨水壺注滿後，機器會進入待機狀態。

9. 取水

9.1 任意點擊一個圖標，點亮屏幕，表示機器進入工作狀態，屏幕亮燈時間為2分鐘。

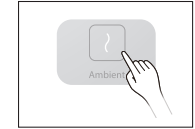

9.2 常溫水

屏幕點亮後，點擊溫水出水鍵即可取常溫淨水。

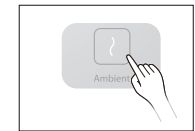

9.3 熱水（95℃）

屏幕點亮後，點擊童鎖，再點擊熱水出水鍵即可取熱水，熱水默認溫度為95℃。

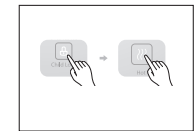

9.4 熱水（其他水溫）

如需選擇其他水溫，點擊調溫鍵，選擇45℃/65℃/85℃/95℃四種水溫，然後點擊童鎖，再點熱水出水鍵即可獲得相應溫度的熱水。

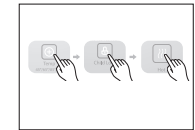

9.5 冷水

屏幕點亮後，如果屏幕雪花標識閃爍，則表示，機器正在製冷，將不能獲得低於8℃的冷水，當雪花標識長亮，則表示製冷結束，此時點擊冷水出水鍵，將獲得低於8℃的冷水；如不需要冷水，長按3秒冷水出水鍵即可取消製冷功能，此時點擊冷水出水鍵，將獲得常溫水。

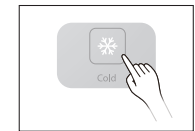

10. 換水提示

當水箱連到最低水位線時，顯示屏的“Tap Water”和缺水圖標閃爍，請倒掉水箱餘水，並往水箱中加入自來水至最高水位，把水箱放置回機器。

11. 缺水提示

當淨水壺的水位處於較低水位時，顯示屏的“pure Water”和缺水圖標閃爍，此時，需要等待1-2分鐘，我們才能操作機器獲得相應溫度的水。

異常情況補充說明：

- 如在沖洗過程中取出原水箱，機器會記錄已沖洗的時間，直到放回水箱繼續沖洗至5分鐘後會提示換水。
- 如在沖洗過程中電源斷開，機器會記錄已沖洗的分鐘整數，恢復電源後會繼續沖洗至5分鐘後會提示換水。

新機水箱中出現“白色粉末”的情況說明：

新機在前期使用時，水箱中會涌出大量密集氣泡，目測類似白色粉末或白色泡沫。該氣泡是RO反滲透膜內的空氣，屬於正常現象，靜止1分鐘左右會消失。該情況是不會影響水質，可以放心飲用，隨着使用次數增加，氣泡會逐漸減少。

TWP-W2265THK(W) Quick Start Guide

Instructions for first use

- When using the product for the first time, please follow the guidelines to prolong the service life of the filter element.

1. Open the package, place the machine on a stable surface and place the water tray.

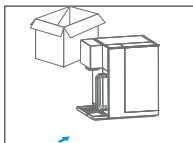

2. Steps to remove the water tank:

- 2.1 Remove the water tank cover;
- 2.2 Lift the handle of the water tank and pull the water tank outward, and then lift it out after it disconnect with the base.

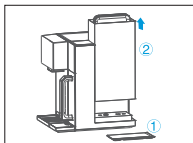

3. Water filling:

Fill the water tank with tap water to the maximum level.

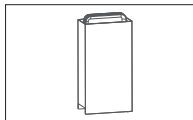

4. Install the water tank:

- 4.1 Align the water tank with the base socket and press down;
- 4.2 Cover the water tank with the cover, ensuring that the top of the water tank cover is aligned with the top of the machine.

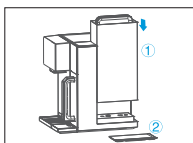

5. Rinse the filter element

- 5.1 Put the water tank back to the machine, and the machine starts to automatically clean and flush the filter element, which is carried out in three times, the flushing time is 5 minutes, and the display screen displays the countdown of 300 seconds.
- 5.2 After the washing of the filter element is finished, the water shortage icon flashes, prompting the user to change the water. At this time, all the water in the original tank needs to be poured out, and the water is re-added to the highest water level.
- 5.3 Repeat Steps 5.1 and 5.2 three times.

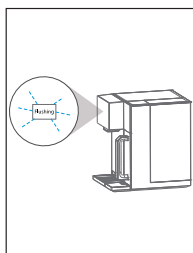

6. Start making water

The water tank is connected to the fourth box of water, and the water is made. The new machine takes about 10~15 minutes to make water, please wait patiently.

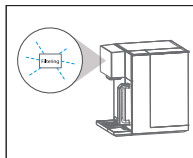

7. After the water making is completed, press the "Ambient Water" button to discharge an appropriate amount of water to clean the internal pipeline and water nozzle, and the machine can be used normally. (optional)



8. When the machine is initially powered on, fill the water tank with water. The machine will start filtering the water until the purified water tank is filled. Once the purified water tank is filled, the machine will enter standby mode.

9. Take water

9.1 Press any icon to light up the screen, indicating that the machine has entered the working state. The screen will remain light for 2 minutes.



9.2 Ambient temperature

Water After the screen is lit, click the warm water key to clean water at room temperature.



9.3 Hot Water

After the screen is lit up, click the child lock, and then click the hot water outlet key to obtain hot water, the default temperature of hot water is 95 °C, if you need to choose other water temperatures, click the temperature adjustment key, select 45 °C/65 °C/85 °C/95 °C four kinds of water temperatures, then click the child lock, and then click the hot water outlet key to obtain the corresponding temperature of hot water.

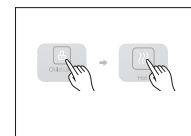

9.4 Cold Water

After the screen is lit up, if the snowflake logo on the screen flashes, it means that the machine is cooling, it will not be able to get cold water below 8 °C. When the snowflake keeps shining, it means that the refrigeration is over. Click the cold water outlet key at this time, and you will get cold water below 8 °C. If you do not need cold water, long press the cold water outlet key for 3 seconds to cancel the cooling function, then click the cold water outlet key, you will get room temperature water.

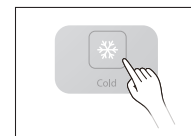
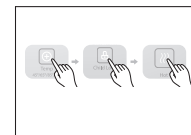

10. Water change tips

When the Water tank is connected to the lowest water level, the Tap Water and water shortage ICONS on the display flash. Please pour out the remaining water in the water tank, add tap water to the water tank to the highest level, and place the water tank back to the machine.

11. Water shortage tips

When the Water level of the pure Water cup is at a low level, the pure water and water shortage ICONS on the display screen flash, at this time, we need to wait 1-2 minutes before we can operate the machine to obtain the corresponding temperature of water.

Supplementary explanation of exceptions:

- If the water tank is lifted during the filtering process, the machine will record filtering time; when the water tank is install back, it continues filtering process until 5 minutes, and then prompts to change the water.
- If there is a power failure during the filtering process, the machine will record the integer number of minutes according to the filtering time. After the power is restored, it continues filtering process until 5 minutes and then prompts to change the water.

Description of "white powder in water tank of new machine":

When the new machine is used, a large number of dense air bubbles will flow out inside the water tank, which looks like white powder or white foam visually. The air bubbles are the air in the RO membrane. It is normal and will disappear after standing still for about 1 minute. This will not affect the water quality. As the number of uses increases, the bubbles will gradually decrease.