

# TOSHIBA

## TWP-TSR76THK(W) TWP-TSR76THK(M) RO座檯式淨飲機快速指引

### 首次使用

- 產品首次使用請按照指引操作，可延長濾芯使用壽命。

1. 打開包裝，將機器放置在穩固的平面上及擺放接水盤，將出水嘴的保護套取下。

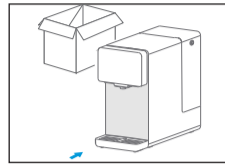

2. 取水箱步驟：

- 2.1 取下水箱蓋；
- 2.2 提起水箱把手往外拉動水箱，待與底座鬆動後再往外提起。

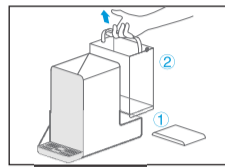

3. 注水：

- 往水箱中加自來水至最高水位。

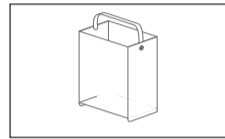

4. 裝上水箱：

- 4.1 將水箱對準底座插孔往下壓；
- 4.2 蓋上水箱蓋，此時水箱蓋頂部與機身頂部平齊。

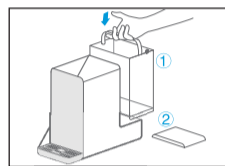

5. 沖洗濾芯：

- 5.1 把水箱放回機器，“Flushing”燈閃爍，機器開始進行自動沖洗濾芯，持續5分鐘。
- 5.2 濾芯沖洗時間結束，響起“滴”三聲，“Flushing”圖標會呈半亮狀態，“Water”燈閃爍。此時需要將水箱的水全部倒掉，並重新加水至最高水位。
- 5.3 重複步驟“5.1”和“5.2”，共3遍。

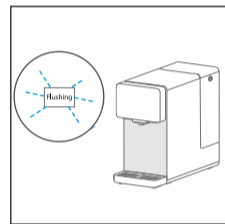

6. 開始制水：

- 水箱接第4箱水，開始制水。新機器制水時間需要約10~15分鐘，請耐心等待。

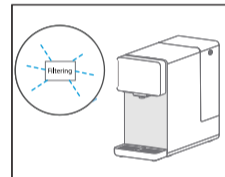

7. 首次制水完成後，準備好大約1.5L的容器，按常溫水鍵“ Ambient Water ” 排出存水。完成後機器才可再次制水並正常使用。

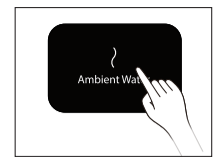

8. 當首次啟動機器時，為原水箱注滿水後，機器開始過濾水，直至淨水箱注滿為止，待淨水箱注滿後，機器會進入待機狀態。

9. 取水

9.1 任意點擊一個圖標，點亮屏幕，表示機器進入工作狀態，屏幕亮燈時間為10分鐘。

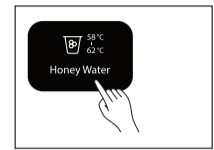

9.2 常溫水

屏幕點亮後，溫度自動選擇為常溫水，點按出水鍵即可取常溫淨水。

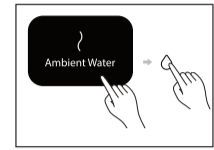

9.3 其餘選項

如取常溫水外的其餘溫度的水時，童鎖鍵會亮起，需要點擊其進行解鎖才能取水。

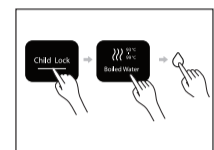

10. 換水提示

當水位達到最低水位線時，顯示屏的“Water”圖標閃爍，請倒掉水箱餘水，並往水箱中加入自來水至最高水位，把水箱放置回機器。

11. 存水排出：

超過48小時未使用機器的情况下，需強制排空淨水箱的水後才能正常使用。此時常溫水鍵“ Ambient Water ”圖標閃爍，需準備大約1.5L容器置於出水嘴下，短按常溫水鍵“ Ambient Water ” 排出存水。

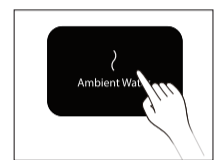

異常情況補充說明：

1. 如在沖洗過程中取出原水箱，機器會記錄已沖洗的時間，直到放回水箱繼續沖洗至5分鐘後會提示換水。
2. 如在沖洗過程中電源斷開，機器會記錄已沖洗的分鐘整數，恢復電源後會繼續沖洗至5分鐘後會提示換水。

新機水箱中出現“白色粉末”的情況說明：

新機在前期使用時，水箱中會涌出大量密集氣泡，目測類似白色粉末或白色泡沫。該氣泡是RO反滲透膜內的空氣，屬於正常現象，靜止1分鐘左右會消失。該情況是不會影響水質，可以放心飲用，隨着使用次數增加，氣泡會逐漸減少。

# TOSHIBA

## TWP-TSR76THK(W) TWP-TSR76THK(M) Quick Start Guide

### Instructions for first use

- When using the product for the first time, please follow the guidelines to prolong the service life of the filter element.

1. Open the package, place the machine on a stable surface and place the water tray and remove the protective cover of the water nozzle.

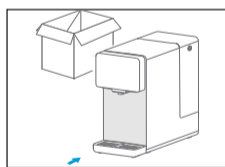

2. Steps to remove the water tank:

- 2.1 Remove the water tank cover;
- 2.2 Lift the handle of the water tank and pull the water tank outward, and then lift it out after it disconnect with the base.

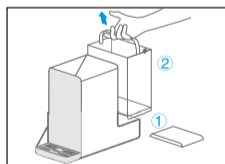

3. Water filling:

- Fill the water tank with tap water to the maximum level.

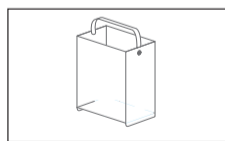

4. Install the water tank:

- 4.1 Align the water tank with the base socket and press down;
- 4.2 Cover the water tank with the cover, ensuring that the top of the water tank cover is aligned with the top of the machine.

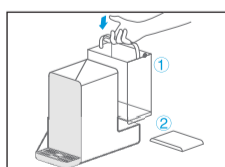

5. Rinse filter:

- 5.1 Put the water tank back into the machine, and the "Flushing" light will flash. The machine will start to flush the filter automatically for 5 minutes.
- 5.2 When it finishes filter flushing, it will beep for 3 times. "Flushing" icon will be half-lit state, and the "Water" icon will flash. At this time, it is necessary to pour out all the water in the water tank and refill it to the highest water level.
- 5.3 Repeat steps "5.1" and "5.2" for a total of 3 times.

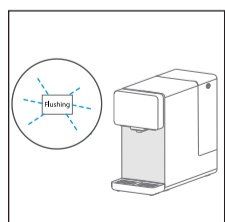

6. Start water making:

- The water tank is connected to the fourth water tank and water making begins. It takes about 10-15 minutes for the new machine to make water, please wait patiently.

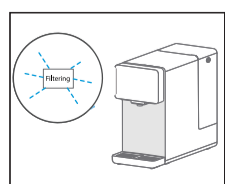

7. After the first-time water production is completed, prepare a container of approximately 1.5L and press the "Ambient Water" button to drain the stored water. After this is done, the machine can be used normally to produce water again.

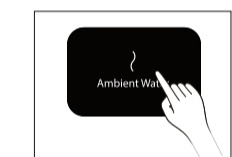

8. When the machine is initially powered on, fill the water tank with water. The machine will start filtering the water until the purified water tank is filled. Once the purified water tank is filled, the machine will enter standby mode.

9. Take water

9.1 Press any icon to light up the screen, indicating that the machine has entered the working state. The screen will remain light for 10 minutes.

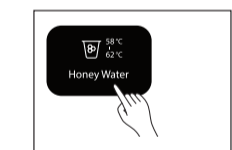

9.2 Ambient water

After the screen is on the temperature automatically defaults to ambient water. Simply press the water outlet button to obtain ambient purified water.

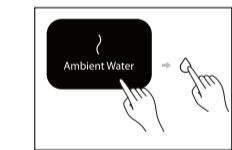

9.3 Other options

When selecting water at temperatures other than ambient water, the child lock button will light up, indicating that you need to press on it to unlock and take the water.

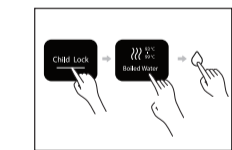

10. Water refill reminder

When the water level reaches the minimum water level, the "Water" icon on the display will flash, please pour out the remaining water from the water tank, and fill the water tank with tap water to the maximum water level, and install the water tank back into the machine.

11. Drain stored water

In the case of not using machine for more than 48 hours, it is necessary to forcibly drain the water tank before normal use. At this time, the room temperature water button "Ambient Water" will flash. Prepare a container of approximately 1.5L under the water outlet, and briefly press the "Ambient Water" button to drain the stored water.

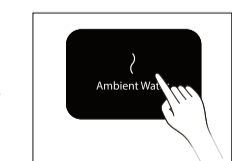

**Supplementary explanation of exceptions:**

1. If the water tank is lifted during the filtering process, the machine will record filtering time; when the water tank is install back, it continues filtering process until 5 minutes, and then prompts to change the water.
2. If there is a power failure during the filtering process, the machine will record the integer number of minutes according to the filtering time. After the power is restored, it continues filtering process until 5 minutes and then prompts to change the water.

**Description of "white powder in water tank of new machine":**

When the new machine is used, a large number of dense air bubbles will flow out inside the water tank, which looks like white powder or white foam visually. The air bubbles are the air in the RO membrane. It is normal and will disappear after standing still for about 1 minute. This will not affect the water quality. As the number of uses increases, the bubbles will gradually decrease.