



# 使用說明書

電風扇  
F-DSB35HK(W)

**TOSHIBA**



# 目錄

---

安全注意事項 .....	01
產品簡介 .....	04
安裝說明 .....	05
使用說明 .....	07
產品參數 .....	10
清潔保養 .....	10
故障排除 .....	10

---

**非常感謝您購買東芝電風扇。**

- 為了正確、安全地使用本風扇，請在使用前仔細閱讀本用戶手冊，並充分理解其內容。
- 請妥善保管本用戶手冊，以備於將來參考之用。

# 安全注意事項

## 安全須知







### 請務必遵循這些說明！

本手冊提供了使用風扇時必須遵守的說明，以防止對用戶、其他人員和財產造成危險。

#### ⚠ 小心

請仔細閱讀“安全操作規則。

#### ⚠ 警告

	如果電源線損壞，必須由製造商或其維修代理或具有類似資格的人員更換，以避免危險。
	僅限室內使用。
	為防止觸電危險，請勿將電器、電源線浸入水中。
	本電器可供身體、感官或精神能力較差或缺乏經驗和知識的人員（包括兒童）使用，前提是有負責其安全的人員監督或指導設備使用。兒童不得玩耍本產品及沒有在監督的情況下進行清潔和維護。
	不使用本產品時以及清潔前，請從插座上拔下本產品的電源插頭。
	請將電器放置在兒童或體弱者接觸不到的地方。避免其在沒有監督的情況下使用電器。

# 安全注意事項

1. 風扇運轉時，切勿將手指、鉛筆或任何其他物體插入網罩。
2. 請勿將風扇放在窗戶附近使用，下雨水可能會造成觸電危險。
3. 僅限家庭使用。



## ⚠注意

- 本節描述了安全事項的內容及重要性，以防止對使用者或他人造成人身傷害或財產損失。請在充分理解下面內容的基礎上閱讀正文，並請務必遵守所描述的安全事項。

 禁止	禁止上下搖擺運行時手動俯仰。
 警告	產品未完成安裝前，請勿接通電源。
 禁止	移動產品時，請切斷電源。
 警告	拆下防護外殼前必須確保產品與電源斷開。
 警告	請勿用濕手插拔電源插頭，避免觸電的危險。
 禁止	產品運轉時，切勿將手指、尖銳物等伸入網罩。
 警告	避免在酸鹼油、殺蟲水、窗簾等物品附近使用。
 禁止	避免在陽關直射、長時間高濕度環境使用。
 禁止	禁止在有易落下懸掛物、易受衝擊或擺放不穩定的地方使用。應放置在平穩的地面上使用本產品，請不要翻倒或傾斜。
 警告	只能使用配備的適配器工作，不得使用其他適配器，以免引起危險。

# 安全注意事項

## ⚠ 可能造成輕傷或者財產損失的事項

 警告	使用前，請先檢查所用電壓是否與產品標識的電壓相同。
 警告	離開機器時或不使用機器的狀態下，請切斷電源，以免電路出現故障發生意外。
 警告	使用前需要先檢查電源線及插頭是否破損。如果電源軟線損壞，為了避免危險，必須由製造商、其維修部或類似部門的專業人員更換。

# 產品簡介

## 各部件名稱

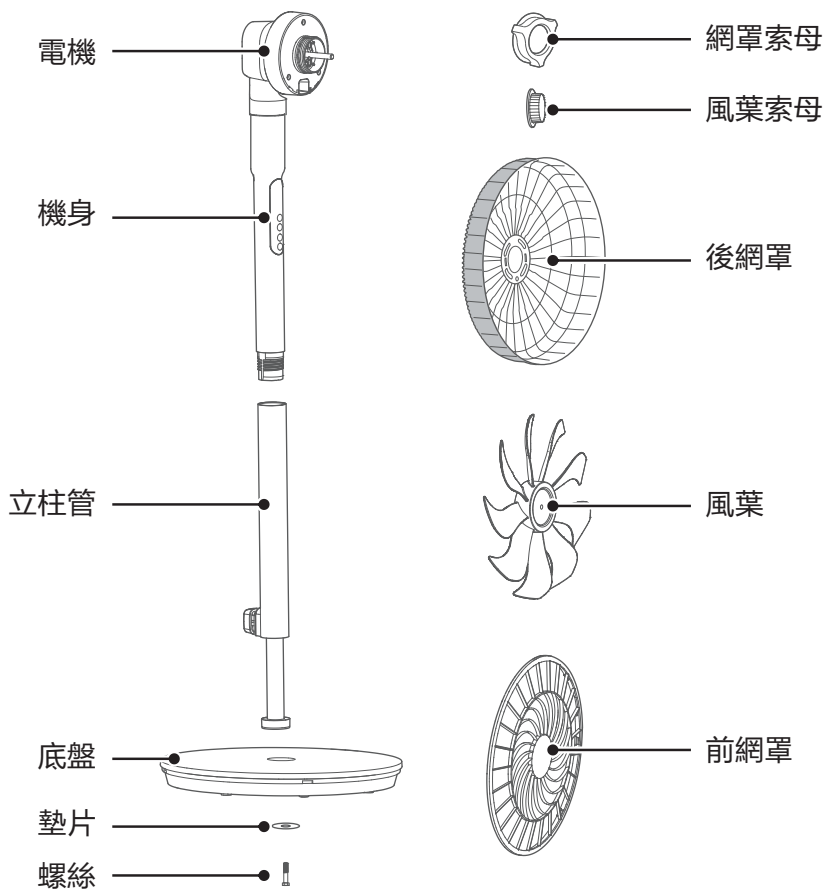

# 安裝說明

## ■ 安裝準備

⚠ 注意

安裝前，請先從機頭螺紋上逆時針旋轉網罩索母並將其取出。

### 1 底盤安裝

將立柱管和底盤對位卡穩，並用螺絲和墊片固定。

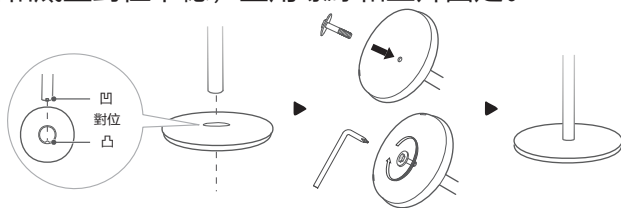

### 2 機身與立柱管安裝

先將機身與立柱管的孔位對準，然後順時針旋轉進行固定。



### 3 後網罩安裝及鎖定

將機頭和後網罩對位，掛上並用網罩索母鎖定。

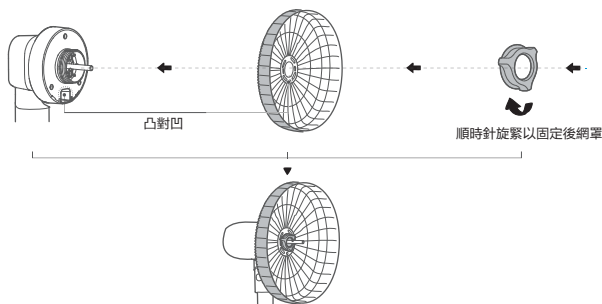



# 安裝說明

## 4 風葉安裝及鎖定

將風葉和電機軸對位並穿上，再用風葉索母鎖定風葉。

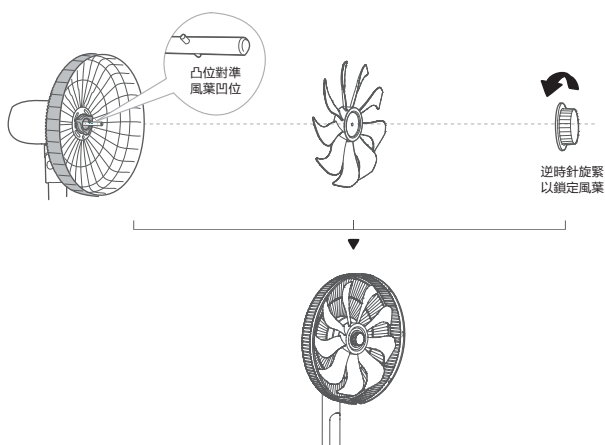

## 5 前網罩安裝及固定

找準前網罩卡扣，東芝標誌擺正。

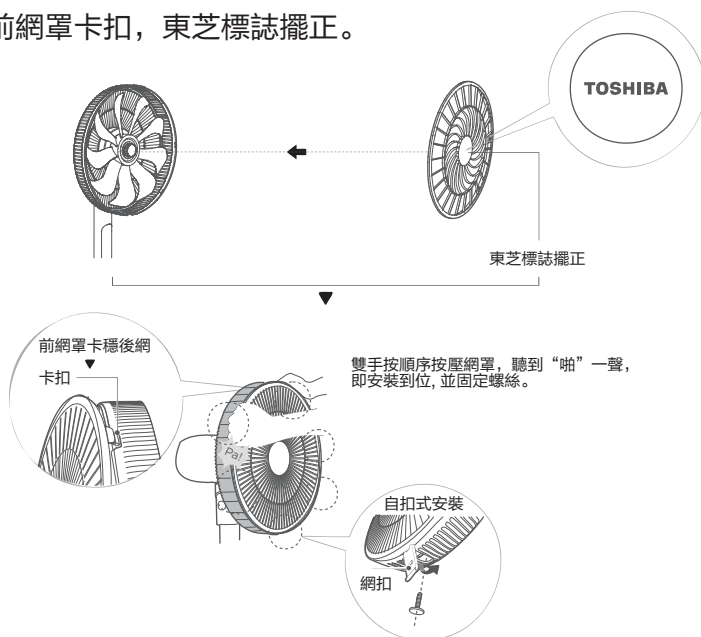

# 使用說明

## 機身操作說明

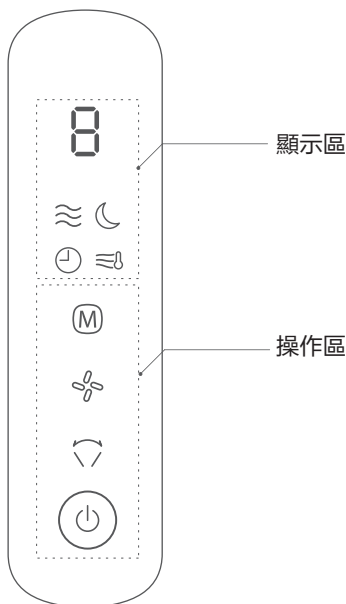

功能	操作說明
	1. 關機狀態下短按，進入開機狀態。 2. 開機狀態下短按，進入關機狀態。
	調節風速。
	設定搖頭操作，短按搖頭一(60°)→(停止)→二(90°)→(停止)→三(120°)→(停止)循環。
	切換風類模式，按正常風→AI風→睡眠風循環。
	1. 開機狀態下，顯示當前風速；搖頭設定下，顯示搖頭檔位；設定定時開機時，顯示開機時間。 2. 關機狀態下，開啟預約開機功能時，顯示開機時間。 3. 短路故障顯示E1；溫度感測器故障顯示E2。
	正常風顯示燈。
	睡眠風顯示燈。
	AI風顯示燈。
	1. 關機狀態下，在預約開機狀態，此圖示點亮。 2. 開機狀態下，若開啟定時開機狀態，則此圖示點亮，否則熄滅。

# 使用說明

## 機身操作說明

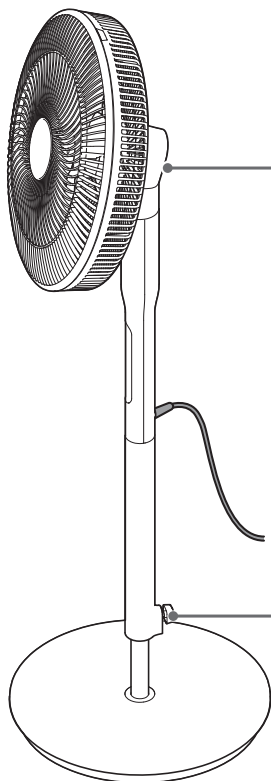

### 調節風向的時候.....

#### 左右調節



#### 上下調節

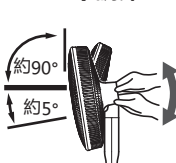

※調節時請注意不要把手指夾到可動部分。

### 調節高度的時候.....

- ① 請先從插座拔下適配器插頭，切斷電源。
- ② 請一邊轉動高度調節杆，一邊拿著支柱進行調節。

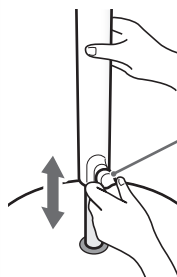

高度調節杆  
(為了安全，操作力度  
稍微變強了)。

※調解時請注意不要把手指夾到可動部分。

# 使用說明

## 遙控器按鍵說明

### ⚠ 注意

- 遙控器在產品正面5米內，左右角度在30度範圍內正常使用。
- 電池中含有許多重金屬和酸堿等物質，威脅人類健康；廢舊電池應分類回收。

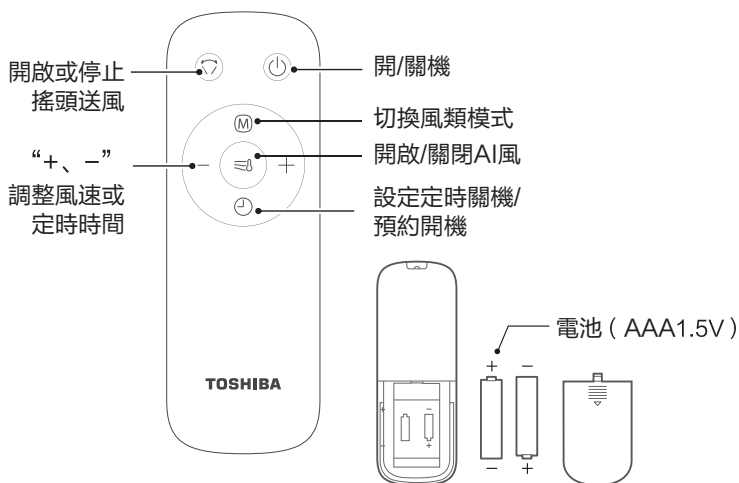

功能	操作說明
	設定搖頭操作，短按搖頭一(60°)→(停止)→二(90°)→(停止)→三(120°)→(停止)循環。
	1. 開機狀態下短按，設定定時關機狀態，或者調節定時時間，最高設定8小時。 2. 關機狀態下短按，設定預約開機狀態，或者調節定時時間，最高設定8小時。
	1. 開機狀態下，短按開啟/關閉AI風。 2. 開啟後，風扇根據室溫自動改變風量。
	1. 開機狀態下，短按增加風速檔位。 2. 在定時設定狀態，增加定時值。
	1. 開機狀態下，短按減少風速檔位。 2. 在定時設定狀態，減小定時值。
	1. 開機狀態下短按，進入開機狀態。 2. 開機狀態下短按，進入關機狀態。
	切換風類模式，按正常風→AI風→睡眠風循環。

# 產品參數

型號	輸入	工作電壓(---)	額定功率(W)	噪音 dB(A)	待機功率(W)	產品尺寸 (mm)
F-DSB35HK(W)	100-240V-50/60Hz 1.5A	24V	11	55	0.8	400x370x1080-1180

# 清潔保養

請勿自行修理電風扇。如果需要維修，請把它交給有資質的維修人員。

1. 在清潔和組裝之前，必須**拔下**風扇的電源線。
2. 為確保電機有充分的通風，請確保電機背面的通風孔沒有灰塵。請勿拆卸風扇以清除灰塵。
3. 請用軟布蘸中性清潔劑擦拭外部部件。
4. 請勿使用任何有研磨性清潔劑或溶劑，以免刮傷表面。請勿使用以下任何一種清潔劑：汽油、稀釋劑。
5. 請勿讓水或任何其他液體進入電機外殼或內部零件。
6. 塑膠部件應使用蘸有中性肥皂液的軟布清潔。用乾布徹底清除肥皂膜。

# 故障排除

如果風扇在使用過程中出現異常情況，請在報修前檢查以下幾點。

問題	檢查以下內容
扇葉不旋轉。	<ul style="list-style-type: none"><li>• 風扇扇葉是否安裝正確？</li><li>• 電源插頭是否插入插座？</li><li>• 是否有扇葉接觸防護罩？</li></ul>
扇葉旋轉但發出奇怪的聲音。	<ul style="list-style-type: none"><li>• 螺旋轂蓋是否正確地將扇葉固定到位？</li><li>• 前後網罩部分是否安裝正確？</li><li>• 是否有扇葉接觸網罩？</li></ul>
	<ul style="list-style-type: none"><li>• 扇葉和網罩是否乾淨？</li></ul>



# INSTRUCTION MANUAL

Stand fan  
F-DSB35HK(W)

**TOSHIBA**







# CONTENTS

---

SAFETY INSTRUCTIONS .....	01
PRODUCT INTRODUCTION.....	04
INSTALLATION INSTRUCTION .....	05
OPERATING INSTRUCTION .....	07
SPECIFICATIONS.....	10
CLEANING ANDMAINTENANCE .....	10
TROUBLESHOOTING.....	10

---

**Thank you very much for purchasing Toshiba electric fan.**

- In order to use this fan correctly and safely, please carefully read this instruction manual to fully understand the content before using it.
- Keep this owner's manual in a handy place for future reference..

# SAFETY INSTRUCTIONS

## Safety precautions







### Always follow these instructions!

This manual provides instructions that must be observed when using the fan in order to prevent danger to the user, other persons, and property.

## CAUTION

Read Rules for Safe Operation and Instructions Carefully.

## WARNING











	If the supply cord is damaged, it must be replaced by manufacturer or its service agent or a similarly qualified person in order to avoid a hazard.
	Indoor use only.
	To protect against the risk of electrical shock, do not immerse the unit, cord or plugin water or other liquid.
	This appliance is not intended for use by persons (including children) with reduced physical, sensory or mental capabilities, or lack of experience and knowledge, unless they have been given supervision or instruction concerning use of the appliance by a person responsible for their safety. Children should be supervised to ensure that they do not play with the appliance.
	When the appliance is not in use and before cleaning, unplug the appliance from the outlet.
	Keep electrical appliances out of reach from Children or infirm persons. Do not let them use the appliances without supervision.

# SAFETY INSTRUCTIONS

1. Never insert fingers, pencils, or any other object through the grille when fan is running.
2. Do not place the fan near the window, or the rainy day may cause electric shock.
3. Household use only.



## NOTE

- This section describes the content and importance of safety matters to prevent personal injury or property damage to users or others. Please read the text with a full understanding of the following content, and be sure to abide by the safety precautions described.

 Prohibited	It is prohibited to tilt manually when horizontal oscillator is activated.
 Warning	Do not connect the power supply until the product is installed.
 Warning	Cut off the power supply before moving the product.
 Warning	Make sure the product is disconnected from the power supply before removing the protective casing.
 Warning	Do not plug or unplug the power plug with wet hands to avoid the risk of electric shock.
 Warning	When the product is running, do not put your fingers or sharp objects into the grille.
 Warning	Avoid using it near acid-base oils, insecticides, curtains and other items.
 Warning	Avoid use in direct sunlight or high humidity environments for long periods of time.
 Warning	It is prohibited to use it in places where there are hanging objects that are easy to fall, where it is susceptible to impacts, or where the placement is unstable. The product should be placed stably when using it, please do not tip over or tilt.
 Warning	Only the matching adapter can be used. Do not use other adapters so as to avoid danger.

# SAFETY INSTRUCTIONS

 Matters that may cause minor injury or property damage

 Warning	Before use, please check whether the voltage used is the same as the voltage marked on the product.
 Warning	When you leave the machine or when the machine is not in use, turn off the power and unplug the power plug to avoid circuit failure and accidents.
 Warning	Before use, check whether the power cord and plug are damaged. If the power cord is damaged, it must be replaced by the manufacturer, its maintenance department or a specialist from a similar department in order to avoid danger.

# PRODUCT INTRODUCTION

## Parts name

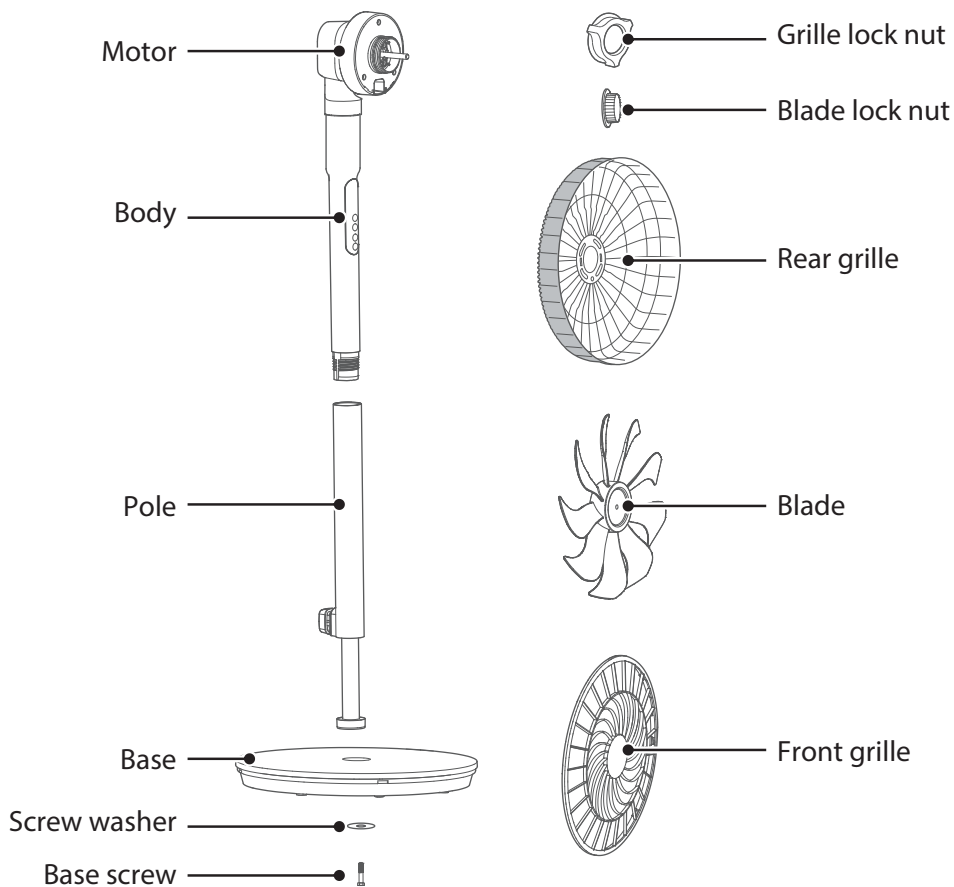

# INSTALLATION INSTRUCTION

## Preparation for installation

### ⚠ ATTENTION

Before installation, please rotate the grille lock nut counterclockwise from the head thread and take it out.

### 1 Assembly of base

Align the pole and the base and secure them with base screw and screw washer.

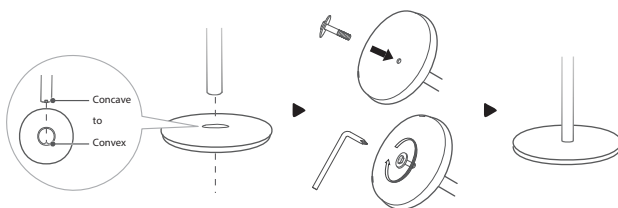

### 2 Assembly of body and pole

First align the holes of the body and the pole, and then rotate clockwise to fix them.



### 3 Assembly and lock of rear grille

Align the head and the rear grille, hang it up and lock it with the grille lock nut.

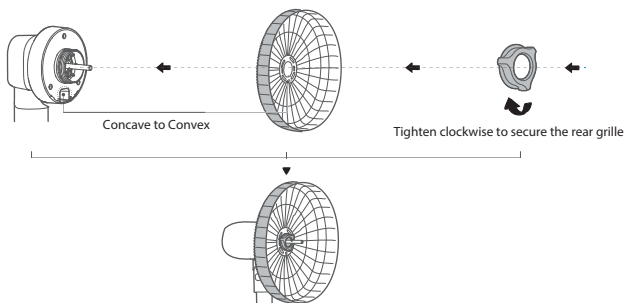

# INSTALLATION INSTRUCTION

## 4 Assembly and lock of blade

Align and thread the fan blade with the motor shaft, and then lock the fan blade with the blade lock nut.

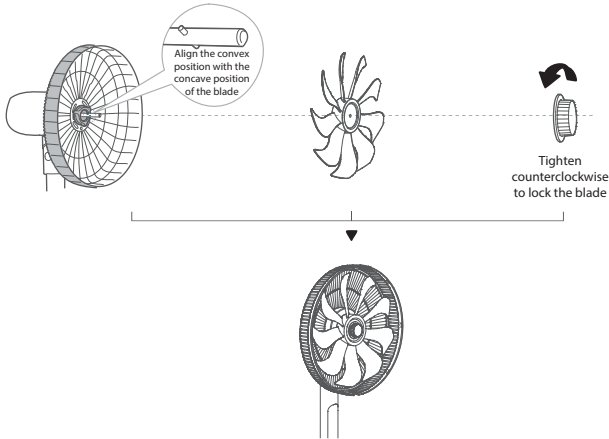

## 5 Assembly and lock of front grille



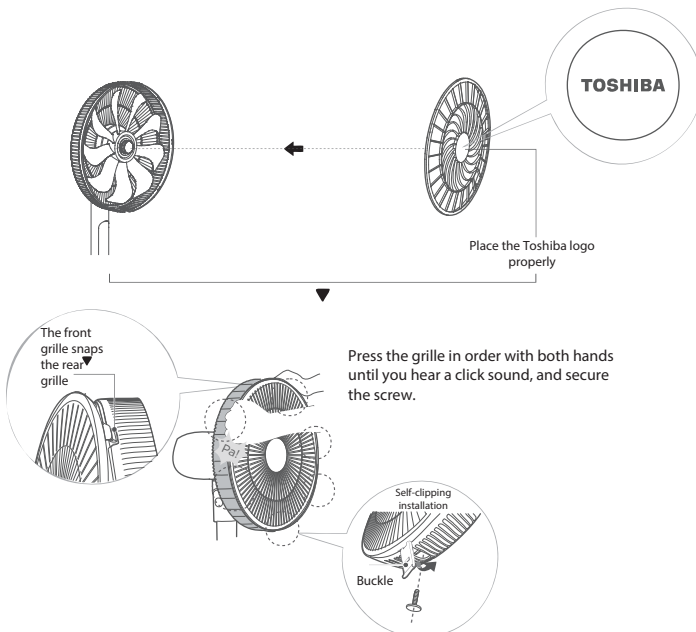



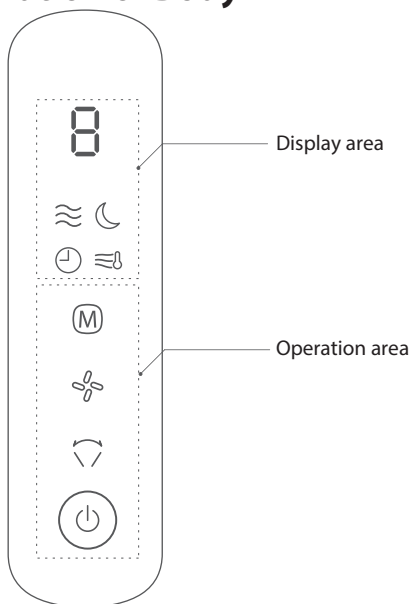

Locate the front grille buckle and align the Toshiba logo.



# OPERATING INSTRUCTION

## Instructions for Operation of Body



Function	Operation instruction
	<ol style="list-style-type: none"> <li>1. In power off state, press it to enter the power on state.</li> <li>2. In power on state, press it to enter the power off state.</li> </ol>
	Adjust wind speed.
	To set the oscillator operation, press to cycle the oscillator among — (60°) → (stop) → 二 (90°) → (stop) → 三 (120°) → (stop).
	To switch the wind mode, press to cycle among normal → AI → sleep.
	<ol style="list-style-type: none"> <li>1. In power on state, the current wind speed is displayed; when the oscillator is set, the oscillator grade is displayed; when the scheduled power off is set, the power off time will be displayed.</li> <li>2. In power off state, press it to enable the scheduled power on function, the power on time will be displayed.</li> <li>3. E1 displays when there is short circuit fault; E2 displays when there is temperature sensor fault.</li> </ol>
	Normal mode indicator light
	Sleep mode indicator light
	AI mode display light
	<ol style="list-style-type: none"> <li>1. In power off state, this icon will light up when the scheduled power-on is enabled.</li> <li>2. In power on state, this icon will light up when the scheduled power-off is enabled, otherwise it will go out.</li> </ol>



# OPERATING INSTRUCTION

## Instructions for Operation of Body

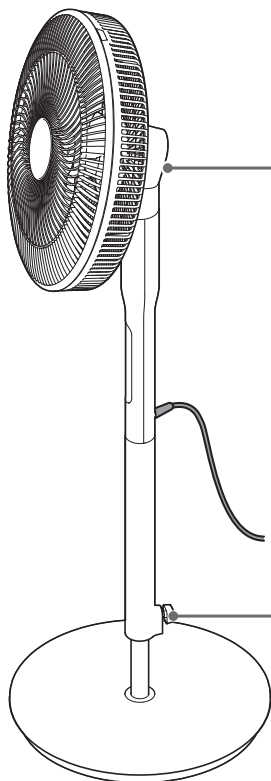

### When adjusting the wind direction

Adjust left  
and right

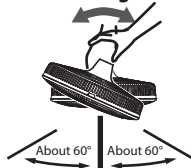

Adjust up and  
down

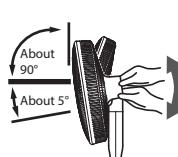

※ Please be careful not to get your fingers caught in the movable part when adjusting.

### When adjusting the height

- ① Please unplug the adapter from the socket first and cut off the power supply.
- ② Adjust the height adjustment lever while holding the pole.

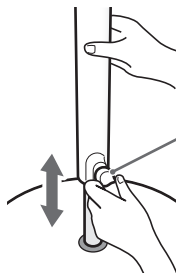

#### Height adjustment lever

(For safety reasons, the operation force has been slightly strengthened.)

※ Please be careful not to get your fingers caught in the movable part when adjusting.

# OPERATING INSTRUCTION

## Instructions for Remote Control

### ⚠ Note

- The remote control should be normally used within 5 meters of the front of the product and 30° of the deviation angle.
- The battery contains many heavy metals, acids and bases, etc., which may threaten human's health. Waste batteries should be recycled separately.

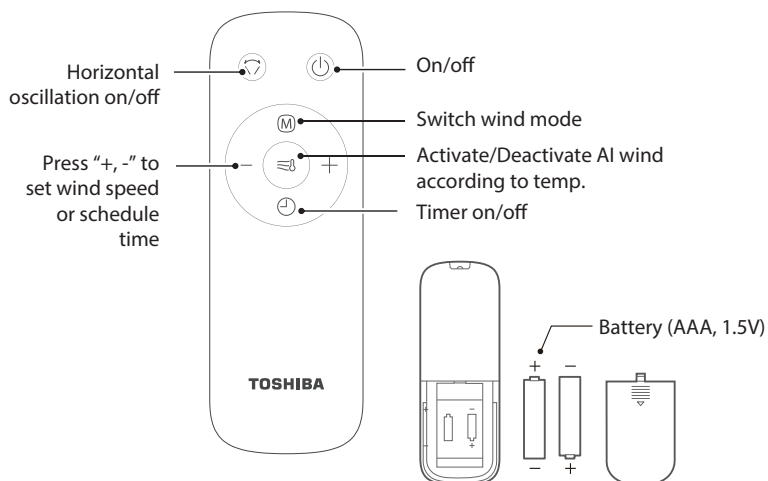

Function	Operation instruction
	To set the oscillator operation, press to cycle the oscillator among — (60°) → (stop) → 二 (90°) → (stop) → ≡ (120°) → (stop).
	<ol style="list-style-type: none"> <li>1. In power on state, press it to set the scheduled power-off state, or adjust the scheduled time, with a maximum setting of 8 hours.</li> <li>2. In power off state, press it to set the scheduled power-on state, or adjust the scheduled time, with a maximum setting of 8 hours.</li> </ol>
	<ol style="list-style-type: none"> <li>1. In power on state, press it to turn on/off the AI wind.</li> <li>2. It will changes the wind speed according to the room temperature.</li> </ol>
	<ol style="list-style-type: none"> <li>1. In power on state, press it to increase the wind speed.</li> <li>2. In timer setting state, increase the timing value.</li> </ol>
	<ol style="list-style-type: none"> <li>1. In power on state, press it to decrease the wind speed.</li> <li>2. In timer setting state, reduce the timing value.</li> </ol>
	<ol style="list-style-type: none"> <li>1. In power off state, press it to enter the power-on state.</li> <li>2. In power on state, press it to enter the power-off state.</li> </ol>
	To switch the wind mode, cycle among normal → AI → sleep.

# SPECIFICATIONS

Model	Rated input	Rated Voltage (---)	Rated power (W)	Noise dB(A)	Standby power (W)	Unit Dimensions
F-DSB35HK(W)	100-240V- 50/60Hz 1.5A	24V	11	55	0.8	400x370x1080-1180

# CLEANING AND MAINTENANCE

The fan requires little maintenance. Do not try to repair it by yourself. Refer it to qualified service personnel if service is needed.

1. Before cleaning and assembling, unplug the fan from the power supply.
2. To ensure adequate air circulation to the motor, keep vents at the rear of the motor free of dust. Do not disassemble the fan to remove dust.
3. Please wipe the exterior parts with a soft cloth soaking a mild detergent.
4. Do not use any abrasive detergent or solvents to avoid scratching the surface. Do not use any of the following as a cleaner: gasoline, thinner.
5. Do not allow water or any other liquid into the motor housing or interior parts.
6. Plastic parts should be cleaned with a soft cloth moisten with mild soap. Thoroughly remove soap with dry cloth.

# TROUBLESHOOTING

In the case of any abnormality when using this fan, please check the following points before requesting repair.

Trouble	Check the following
<b>The blades do not rotate.</b>	<ul style="list-style-type: none"><li>• Is the Fan blade installed properly?</li><li>• Is the power plug properly inserted into the outlet?</li><li>• Are any of the blades contacting guard?</li></ul>
<b>The blades spin but make a strange sound.</b>	<ul style="list-style-type: none"><li>• Is the spinner properly holding the blades in position?</li><li>• Are the front and rear guard sections properly mounted?</li><li>• Are any of the blades contacting guard?</li></ul>
	<ul style="list-style-type: none"><li>• Are the blades and guard clean?</li></ul>

**#DetailsMatter**